

Flowmatic® Automatic Flusher Ceiling/Wall Mounted for Urinal

Specification Data Sheet



Features

Exposed Plate

- 4mm thick stainless steel with 4mm radius corners.
- Back mounted applications plates have no front penetrations and are fixed from the duct.
- Soap holder is angled to minimise water puddling and hiding of contraband.

Controller Requirements

- The control box and sensors must be mounted within 3 metres of the supply valve.
- A 220 - 240V 50Hz 10 amp general purpose outlet must be supplied within 1 metre of the control box.
- All plumbing must comply with AS/NZS3500.

To Specify

Galvin Specialised Flowmatic® automatic flusher is fully concealed and utilises advanced technology that easily adapts to the required situation and environment. The demand for automatic flushers has been heightened by the community's awareness that disease can be spread by touching contaminated appliances and also by the increased vandalism of cisterns. The Flowmatic® automatic flusher combats these issues and is your best choice for new and existing projects.

Code:

TZ-FLOWFLUS – Flowmatic® Automatic Flusher Ceiling/Wall Mounted for Urinal 15mm 24vAC



A family
owned
Australian
business



Typical Dimensions

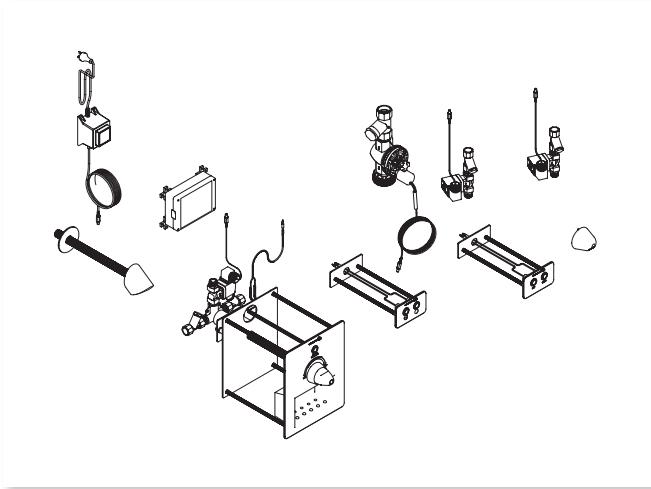

Technical Information

- Inlet: 1/2" BSP - Male
- Outlet: 1/2" BSP - Female
- Working Pressure Range (kPa): 100 Min - 1000 Max
- Working Temperature Range (°C): 5 Min - 90 Max
- Activation: Motion Sensor

Maintenance & Cleaning

Galvin Specialised products should be cleaned with a soft damp cloth using only mild liquid detergent or soap and water. Do not use cleaning agents containing a corrosive acid, scouring agent or solvents. Do not use cream cleaners, as they are abrasive. Use of unsuitable cleaning agents may damage the surface. Any damage caused in this way will not be covered by warranty.

Regular maintenance should be carried out in accordance with the installation and troubleshooting guides provided with the product, relevant Australian Standards, local authorities and state codes.

As part of maintaining a safe and reliable plumbing system, we recommend tapware and valves are operated on at least a daily basis.

Warranty

Galvin Engineering products are covered under our Manufacturer's Warranty at www.galvinengineering.com.au. Galvin Engineering products must be installed in accordance with the installation instructions and in accordance with AS3500 and the PCA, relevant Australian Standards and local authorities applicable to product being installed. Water and electrical supply conditions must also comply to the applicable national and/or state standards, failing to comply with these provisions may void the product warranty and affect performance of the product.

Whilst all reasonable care has been taken in compiling the information in this document, the designs, dimensions and products shown are indicative only and should not be relied upon without our prior approval. Due to our policy of continuous development, we reserve the right to alter any details of specifications or products without notice. All information, drawings, technical specifications and product designs remains the property of Galvin Engineering Pty Ltd.

Within Australia: **1300 514 074** Outside Australia: P: +61 (0)8 9338 2344
 F: +61 (0)8 9338 2340
sales@galvinengineering.com.au
www.galvinengineering.com.au
 ABN: 78 008 719 382

A business unit of

GalvinEngineering
 the mark of reliability



PERTH | SYDNEY | MELBOURNE | BRISBANE | ADELAIDE | UNITED STATES OF AMERICA | UNITED KINGDOM | NEW ZEALAND